

零件图	成品图	客户图
	○	

REVISION DATA				
REV	ECN No.	DESCRIPTION	NAME	DATE
A0		NEW DRAWING	Harvey Li	2023-10-10

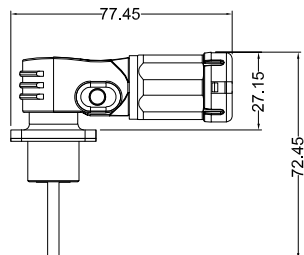

闭合状态

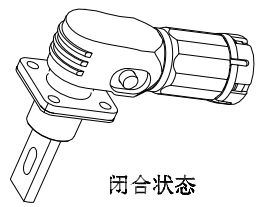

闭合状态

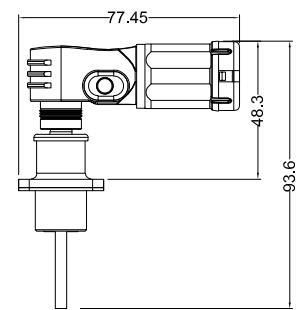
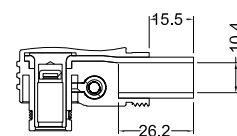
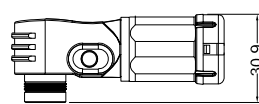
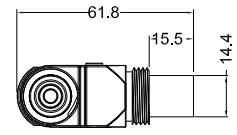
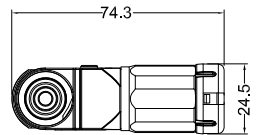

开启状态

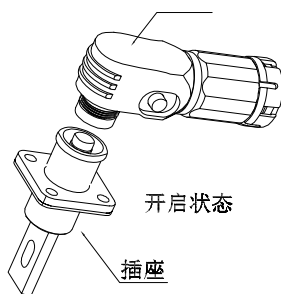

开启状态

插座

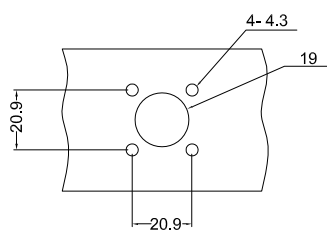

面板开孔尺寸

插座铜牌类型

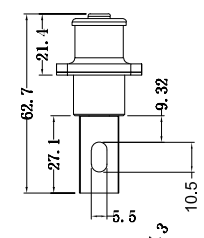

通孔 (T)

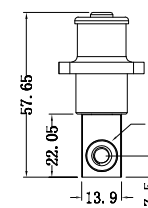

压铆螺母 (M)

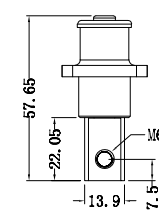

螺纹通孔 (L)

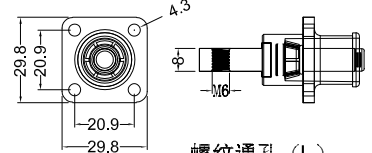
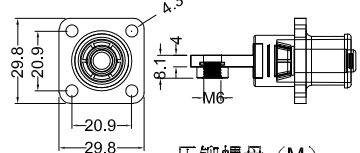
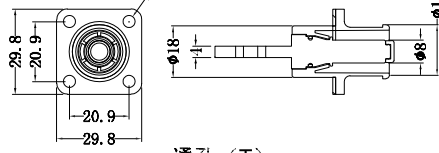

- 技术要求**
- 使用寿命: ≥ 500 次
 - 配线范围: 35mm²-50mm² 非屏蔽线缆
 - 插拔力: <100N
 - 额定电压: 1500V DC
 - 额定电流: 最大250A
 - 绝缘电阻: >2000mΩ
 - 绝缘耐压: 3000V AC
 - 防护等级: IP67 (闭合状态)
 - 防触摸: IP2XB
 - 工作温度: -40℃~125℃
 - 零件表面无毛边、变形、裂痕、缺料等不良现象

ANYCONN® 东莞市恩康电子科技有限公司
 www.cnkcom.com
 TEL:+86(0)769 8904 9672
 FAX:+86(0)769 8904 9671
 E-MAIL:sales@anyconn.com

DONGGUAN ENKANG ELECTRONICS TECHNOLOGY CO.,LTD

TOLERANCE ANGLE ±5° X.XXX ±0.15 X.XX ±0.25 X.X ±0.40 X. ±0.50	DATE :	2023-10-10	TITLE:	储能φ8mm弯插连接器									
	DRAWN :	Harvey Li	CHECKED :	PART NO: STCN-XX-XX									
	APPROVED :		PROJECTON						REV:	A0	UNIT:	mm	SCALE: