

零件图	成品图	客户图
		○

REVISION DATA				
REV	ECN No.	DESCRIPTION	NAME	DATE
A0		NEW DRAWING	D.Y.Y	2023-03-31

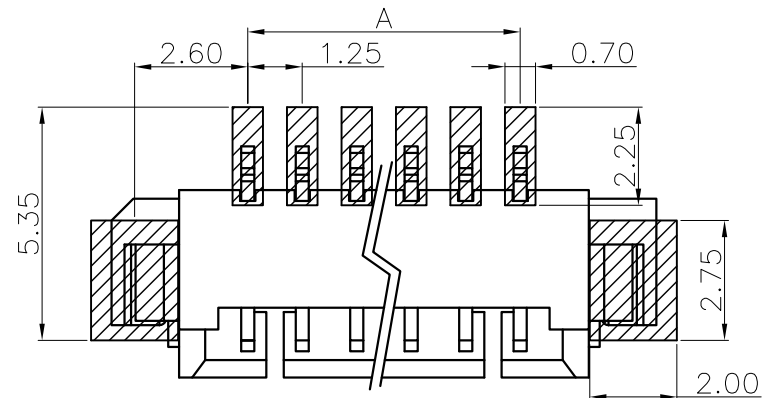

Recommended P.C.B Layout

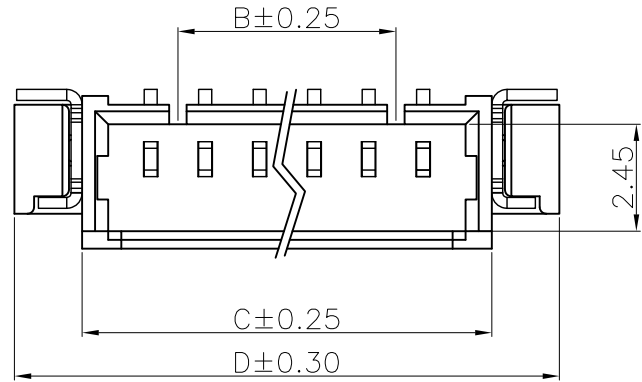
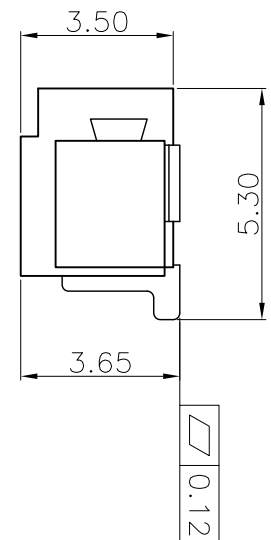
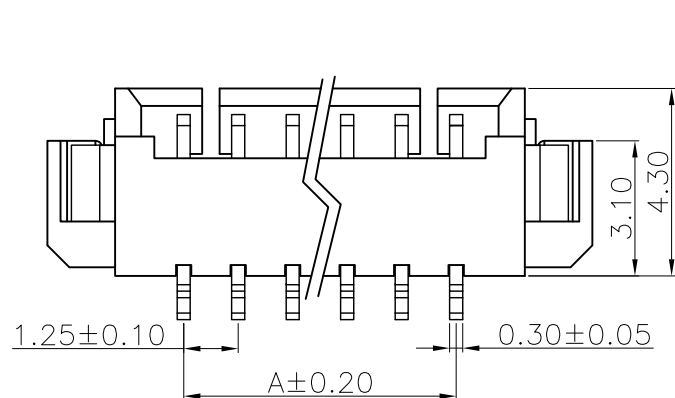

Technical Data

CURRENT RATING:1A AC/DC.
 VOLTAGE RATING:125V AC/DC
 TEMPERATURE RANGE:-25°C~+85°C.
 Insulation resistance:100MΩ Min.
 Contact resistance: ≤30mΩ
 Withstanding voltage: 250V AC/minute.
 Material:
 Housing:LCP,UL94V-0.
 PIN:Copper Alloy

Poles	A	B	C	D
2P	1.25	/	4.40	7.50
3P	2.50	/	5.65	8.75
4P	3.75	2.50	6.90	10.00
5P	5.00	3.75	8.15	11.25
6P	6.25	5.00	9.40	12.50
7P	7.50	6.25	10.65	13.75
8P	8.75	7.50	11.90	15.00
nP

WF	C	H	11	XXX	XX	X	D	N	H030
Pitch(mm) A 2.5 B 2.0 C 1.25 D 3.96 E 2.54 F 3.0 G 1.0	Angel Options R 90° D 180° S SMT H 卧式SMT	Product Type 11 Single row	No. of Positions XXX Poles	Pin Plating G0 Gold Flash SN Tin Plated T3 雾锡	Colour B Black W White		Insulator Material B PA66 D LCP	W With peg N NO Peg L with lock T Fixed Tabs	Series NO.

ANYCONN®
 www.anyconn.com
 TEL:+86(0)769 8904 9672
 FAX:+86(0)769 8904 9671
 E-MAIL:sales@anycom.tw

东莞市恩康电子科技有限公司
DONGGUAN ENKANG ELECTRONICS TECHNOLOGY CO.,LTD

TOLERANCE	DATE : 2023-03-31	TITLE:
ANGLE ±5°	DRAWN : D.Y.Y	Wafer PH1.25 H4.30 W3.50
X.XXX ±0.15	CHECKED :	PART NO: WFCH11XXXXXXDNH030
X.XX ±0.25	APPROVED :	
X.X ±0.40	PROJECTON	
X. ±0.50		REV: A0

UNIT: mm SCALE: 1:1 SIZE: A4 PAGE: 1/1