

4

3

2

1

REVISION DATA

REV	DESCRIPTION	DATE
A0	NEW DRAWING	2018-01-17

CUSTOMER USES PULL OUT DIRECTION

RECEIVING DIRECTION

U TYPE HOLE SC 5:1

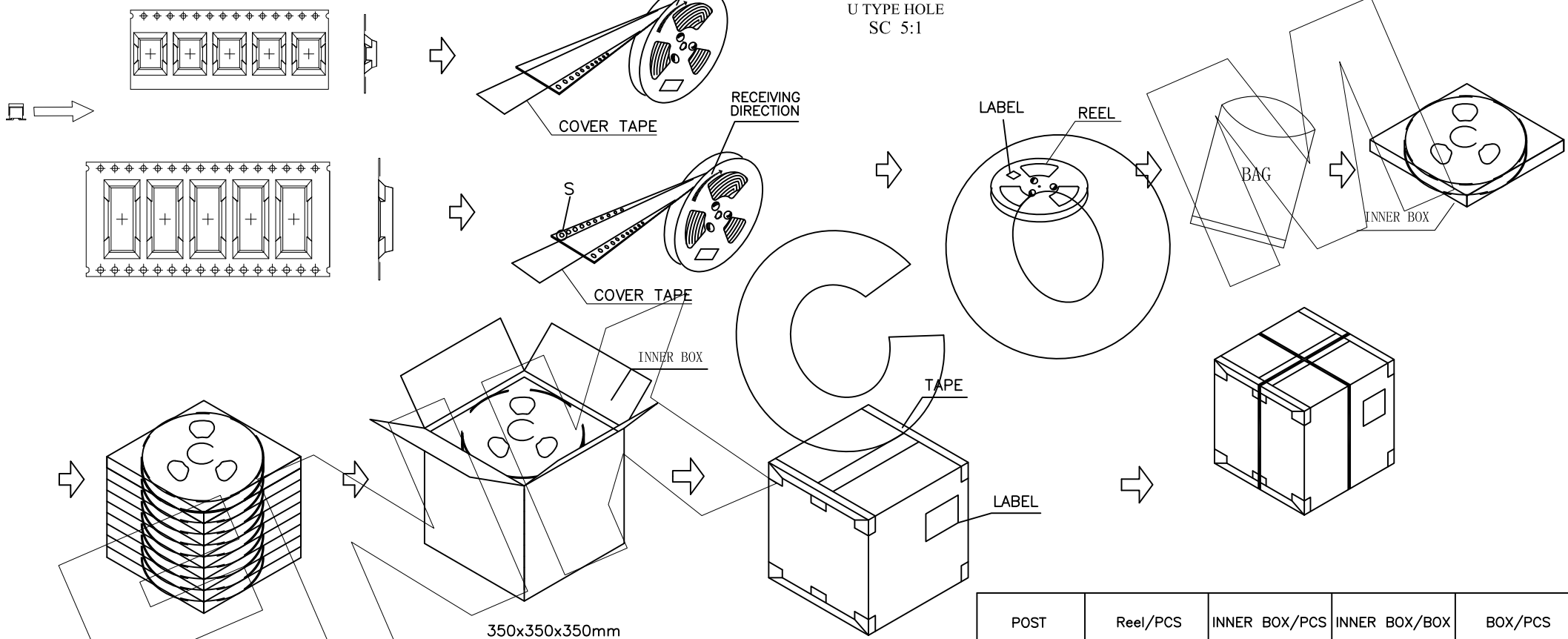

350x350x350mm

PACKAGE DESCRIPTION:

- STEP 1: PUT THE FINISHED PRODUCT INTO THE REEL OF REEL, AND LABEL EACH ROLL
- STEP 2: PUT THE REEL INTO THE VACUUM BAG, REMOVE THE VACUUM, AND THEN PUT IT INTO THE INNER BOX.
- STEP 3: FOLD THE INNER BOX AND PUT IT INTO AN OUTER BOX
- STEP 4: SEAL THE BOX WITH ADHESIVE TAPE
- STEP 5: LABEL THE UPPER RIGHT CORNER OF THE UPPER SIDE OF THE OUTER BOX
- STEP 6: PACK THE TIE

POST	Reel/PCS	INNER BOX/PCS	INNER BOX/BOX	BOX/PCS
2x07P	1500	1500	11	16500
2x17P	1500	1500	7	10500

ENKCOM®
 www.enkcom.com
 TEL:+86(0)769 8904 9672
 FAX:+86(0)769 8904 9671
 E-MAIL:sales@anycom.tw

东莞市恩康电子科技有限公司
DONGGUAN ENKANG ELECTRONICS TECHNOLOGY CO.,LTD

TOLERANCE	PROJECTON	TITLE:
ANGLE ±5°	DATE :	PH1.00 H2.20mm Dual Row SMTFemale Header -Reel Picking
X.XXX ±0.10	DRAWN :	PART NO: F11212XXXXXSXBNC0CP
X.XX ±0.20	CHECKED :	
X.X ±0.30	APPROVED :	REV: A0
X. ±0.50		UNIT: mm
		SCALE: 1:1
		SIZE: A4

4

3

2

1