

零件图	成品图	客户图
		○

REVISION DATA				
REV	ECN No.	DESCRIPTION	NAME	DATE
A0		NEW DRAWING	D.Y.Y	2023-03-18

Technical Data

Material:
 Terminal: High Performance Copper Alloy(C1100)
Plating:
 Contact Area: Selective Plating.
 Soldering Area: Gold or 100u" Matte Tin Plating.
 Under Plating: Nickel Plating 50u" thickness Min. over all
Housing: See the Part No.
CAP: LCP, UL94V-0, HF, Color: Black

Product Specification Refer To : EK-QB-GC-290A

Operating temperatures: Gold Plated: -55°C to +105°C
 Tin plated: -40°C to +105°C

Part No: WFJD12 XXX XX XX X D X 19

PIN数: 002 (2x1P)
 004 (2x2P)
 006 (2x3P)
 以此类推

电镀规格:
 T3: 100u" 雾锡 (Matte Tin)
 G1: 全金1u" (Full Gold Flash)
 G6: 全金测点镀金10u"
 G7: 全金测点镀金15u"
 G8: 全金测点镀金30u"
 M6: 半金雾锡测点镀金10u"
 M7: 半金雾锡测点镀金15u"
 M8: 半金雾锡测点镀金30u"

DIP"L" /CAP帽/包装方式:
 A: 2.4mm/无CAP/盘装
 B: 3.5mm/无CAP/盘装
 C: 2.4mm/无CAP/卷装 PH: 28.0mm
 D: 3.5mm/无CAP/卷装 PH: 28.0mm
 E: 2.4mm/有CAP/卷装 PH: 28.0mm
 F: 3.5mm/有CAP/卷装 PH: 28.0mm

HOUSING 塑胶材质:
 CB: PA6T 黑色 (Black) HF
 DB: LCP 黑色 (Black) HF
 CN: PA6T 本色 (Natural) HF
 DN: LCP 本色 (Natural) HF

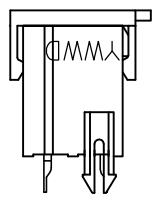
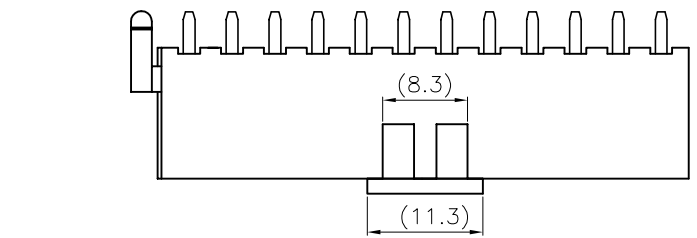

2x2P以下喷码位置

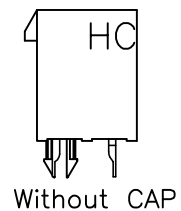
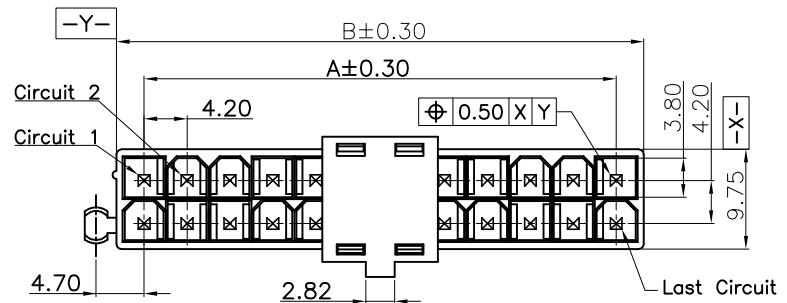

Without CAP

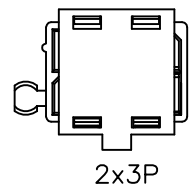

2x3P

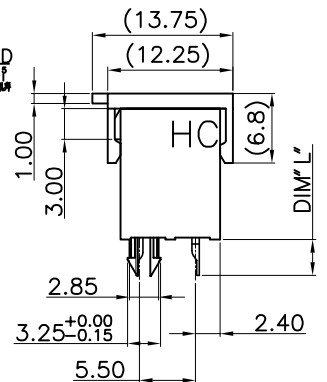
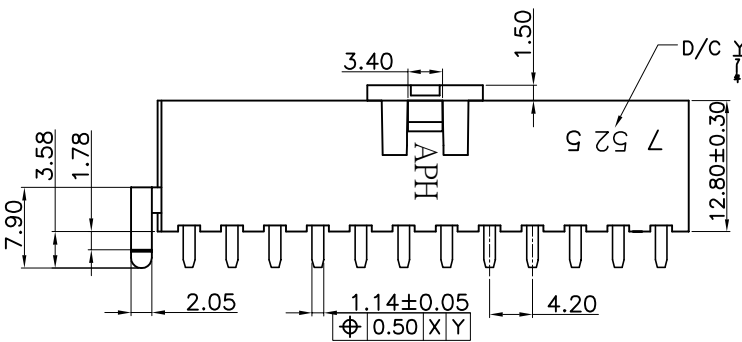

With CAP

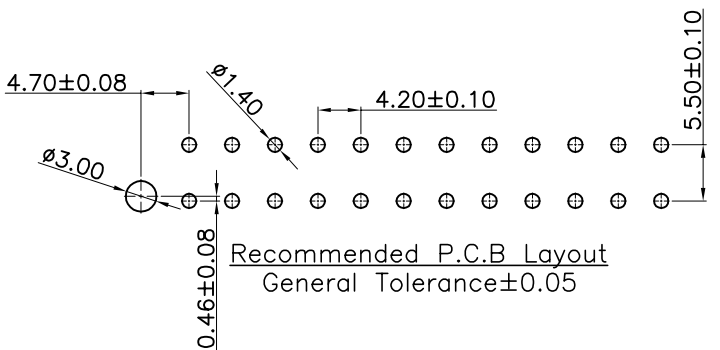

Pin	Dimensions	
	A	B
2x1PIN	4.20	5.40
2x2PIN	8.40	9.60
2x3PIN	12.60	13.80
2x4PIN	16.80	18.00
2x5PIN	21.00	22.20
2x6PIN	25.20	26.40
2x7PIN	29.40	30.60
2x8PIN	33.60	34.80
2x9PIN	37.80	39.00
2x10PIN	42.00	43.20
2x11PIN	46.20	47.40
2x12PIN	50.40	51.60

ANYCONN®
 www.enkcom.com
 TEL: +86(0)769 8904 9672
 FAX: +86(0)769 8904 9671
 E-MAIL: sales@anyconn.com

东莞市恩康电子科技有限公司
DONGGUAN ENKANG ELECTRONICS TECHNOLOGY CO.,LTD

TOLERANCE	DATE : 2023-03-18	TITLE: Mini Power Plus Connect PH4.20 Straight DIP Type
ANGLE ±5°	DRAWN : D.Y.Y	PART NO: WFJD12XXXXXXXXDX19
X.XXX ±0.10	CHECKED :	
X.XX ±0.20	APPROVED :	
X.X ±0.30	PROJECTON	REV: A0
X. ±0.50		UNIT: mm
		SCALE: 1:1
		SIZE: A4
		PAGE: 1/2

零件图	成品图	客户图
		○

REVISION DATA				
REV	ECN No.	DESCRIPTION	NAME	DATE
A0		NEW DRAWING	D.Y.Y	2023-03-18

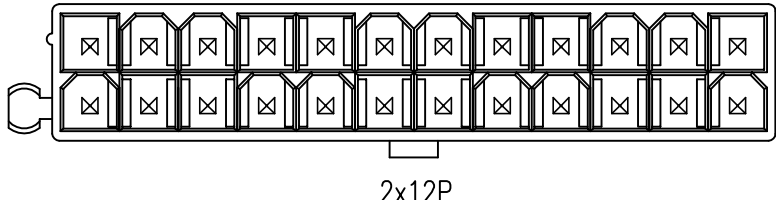
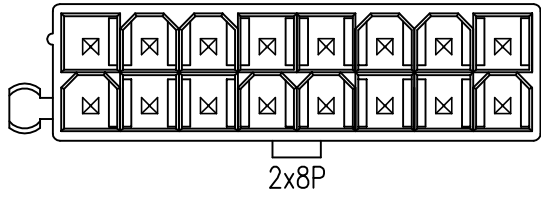
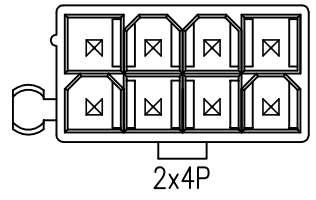
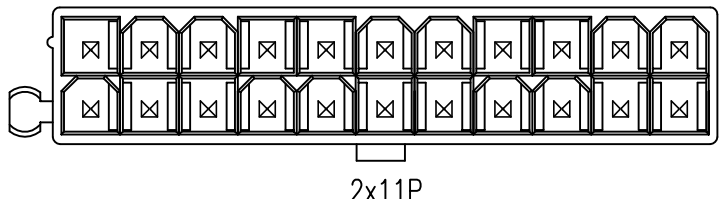
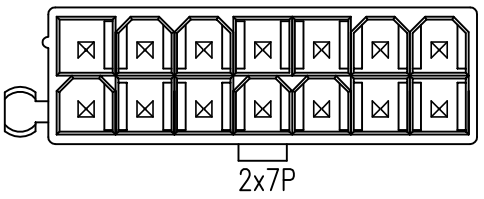
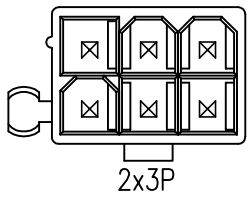
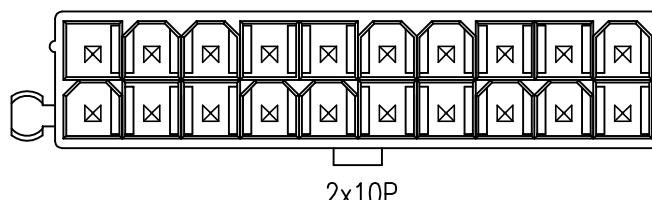
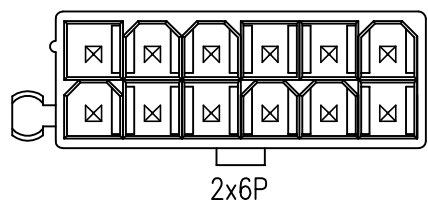
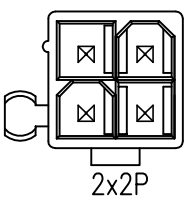
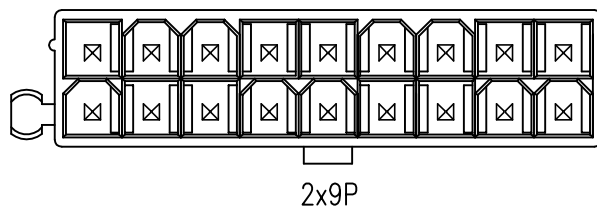
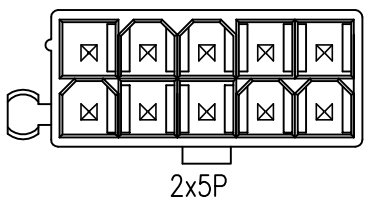
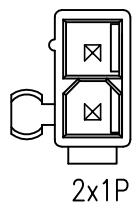

ANYCONN® 东莞市恩康电子科技有限公司
 www.enkcom.com
 TEL:+86(0)769 8904 9672
 FAX:+86(0)769 8904 9671
 E-MAIL:sales@anycom.tw
DONGGUAN ENKANG ELECTRONICS TECHNOLOGY CO.,LTD

TOLERANCE	DATE :	2023-03-18	TITLE: Mini Power Plus Connect PH4.20 Straight DIP Type		
ANGLE ±5°	DRAWN :	D.Y.Y			
X.XXX ±0.10	CHECKED :		PART NO: WFJD12XXXXXXXXDX19		
X.XX ±0.20	APPROVED :				
X.X ±0.30	PROJECTON		REV: A0	UNIT: mm	SCALE: 1:1
X. ±0.50			SIZE: A4	PAGE: 2/2	