

|     |     |     |
|-----|-----|-----|
| 零件图 | 成品图 | 客户图 |
|     |     | ○   |

| REVISION DATA |         |             |         |            |
|---------------|---------|-------------|---------|------------|
| REV           | ECN No. | DESCRIPTION | NAME    | DATE       |
| A0            |         | NEW DRAWING | Songjun | 2020-10-17 |

### Technical Data

Material:  
 Contact Material: Copper Alloy  
 Contact plating: Au or Sn Over Ni  
 Insulator Material: PA46, UL94 V-0

Electrical:  
 Rating current: 1Amps/contact max.  
 Rating voltage : 60 V AC/DC  
 Contact resistance:  $\leq 4m\Omega$ /contact  
 Insulation resistance:  $\geq 1000M\Omega$   
 Withstanding Voltage: 500V AC/minute

Mechanical:  
 Operating temperatures: Gold Plated:  $-55^{\circ}C$  to  $+105^{\circ}C$   
 Tin plated:  $-40^{\circ}C$  to  $+105^{\circ}C$   
 Soldering temperature:  $+260^{\circ}C$ , max(PA46)

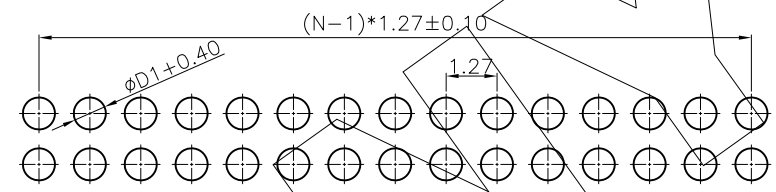
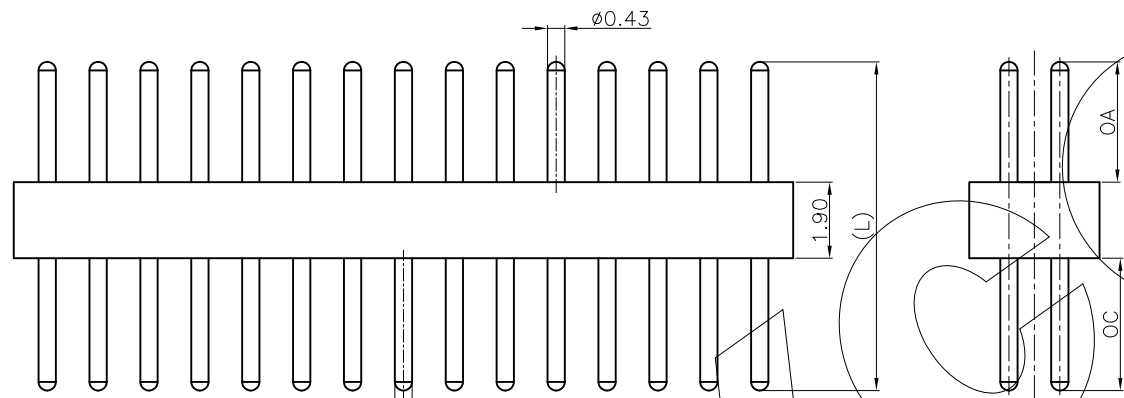
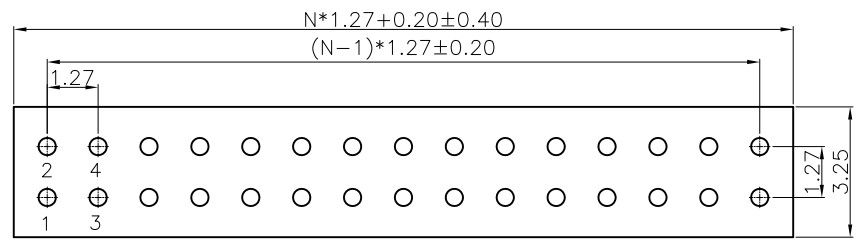

Recommended P.C.B Layout  
 General Tolerance  $\pm 0.05$

|      | OA   | OC   | D1   | L    |
|------|------|------|------|------|
| DIM. | 2.50 | 2.00 | 0.40 | 6.70 |
|      | 3.00 | 2.50 | 0.55 | 7.70 |
|      | 3.50 | 2.80 | 0.60 | 8.50 |

Dim OA&OC&D1&L can be customized by customers

|  |                                   |   |   |   |   |   |   |                          |                 |    |
|--|-----------------------------------|---|---|---|---|---|---|--------------------------|-----------------|----|
| PG   | D                                 | XXX   | 1   | 2   | J   | X   | 00  | XXXXX                    | 0               | 00 |
| Angel Options<br>D 180°<br>R 90°<br>S SMT<br>H H-SMT | No. of Positions<br>XXX Positions | Dip Spacing<br>0 No<br>1 1.27mm<br>2 2.54mm<br>3 7.62mm<br>4 10.16mm<br>5 2.54mm<br>6 15.24mm<br>9 22.86mm<br>A 2.00mm<br>S Special | Insulator Height<br>0 No<br>1 1.20 mm<br>2 1.90 mm<br>3 2.80 mm<br>4 2.10 mm<br>5 2.80 mm<br>7 3.80 mm<br>8 3.80 mm<br>9 4.10 mm<br>A 4.20 mm<br>B 7.00 mm<br>S Special | Insulator type<br>J PA46 Single Row<br>J PA46 Two Row | Pin Plated<br>0 No<br>1 Tin120u"<br>2 Tin200u"<br>3 Gold10.4u"<br>4 Gold0.8u"<br>5 Gold1u"<br>6 Gold1.5u"<br>7 Gold2u"<br>8 Gold3u"<br>9 Gold5u"<br>A Gold8u"<br>B Gold10u"<br>C Gold15u"<br>D Gold30u"<br>E Ag plated<br>F Nickel 80u" | Clp plated<br>0 No<br>1 Tin120u"<br>2 Tin200u"<br>3 Gold10.4u"<br>4 Gold0.8u"<br>5 Gold1u"<br>6 Gold1.5u"<br>7 Gold2u"<br>8 Gold3u"<br>9 Gold5u"<br>A Gold8u"<br>B Gold10u"<br>C Gold15u"<br>D Gold30u"<br>E Ag plated<br>F Nickel 80u" | Pin length(mm)<br>XXXXX XX.Xmm<br>S Special | Insulator Option<br>0 No | Series<br>00 No |    |

**ANYCONN®** 东莞市恩康电子科技有限公司  
 www.anyconn.com  
 TEL:+86(0)769 8904 9672  
 FAX:+86(0)769 8904 9671  
 E-MAIL:sales@anyconn.com

**DONGGUAN ENKANG ELECTRONICS TECHNOLOGY CO.,LTD**

|                       |            |            |                               |  |            |          |           |
|-----------------------|------------|------------|-------------------------------|--|------------|----------|-----------|
| TOLERANCE             | DATE :     | 2020-10-17 | TITLE:                        | PH1.27 IC Sockets Male Dual Row 180° DIP |            |          |           |
| ANGLE $\pm 5^{\circ}$ | DRAWN :    | Songjun    | PART NO: PGDXXX12JX00XXXXX000 |  |            |          |           |
| X.XXX $\pm 0.15$      | CHECKED :  |            |                               |  |            |          |           |
| X.XX $\pm 0.25$       | APPROVED : |            |                               |  |            |          |           |
| X.X $\pm 0.40$        | PROJECTON  |            | REV: A0                       | UNIT: mm                                 | SCALE: 1:1 | SIZE: A4 | PAGE: 1/1 |